



PROJECT INFORMATION

Project Title: NEDU Injection Leak
Project Type: ENERGY DEVELOPMENT, OIL AND GAS DEVELOPMENT
Latitude/Longitude (DMS): 32.489609 / -103.146832
County(s): LEA
Project Description: A desktop review for a spill site

REQUESTOR INFORMATION

Project Organization:
Contact Name: Trevor Hartwig
Email Address: thartwig@ensolum.com
Organization: Ensolum, LLC
Address: 11049 West 44th Avenue, Wheat Ridge CO 80033
Phone: 3038172989

OVERALL STATUS

This report contains an initial list of recommendations regarding potential impacts to wildlife or wildlife habitats from the proposed project; see the Project Recommendations section below for further details. Your project proposal is being forwarded to a New Mexico Department of Wildlife (Department) biologist for review to determine whether there are any additional recommendations regarding the proposed actions. A Department biologist will be in touch within 30 days if there are further recommendations regarding this project proposal.

About this report:

- This environmental review is based on the project description and location that was entered. The report must be updated if the project type, area, or operational components are modified.
- This is a preliminary environmental screening assessment and report. It is not a substitute for the potential wildlife knowledge gained by having a biologist conduct a field survey of the project area. Federal status and plant data are provided as a courtesy to users. The review is also not intended to replace consultation required under the federal Endangered Species Act (ESA), including impact analyses for federal resources from the U.S. Fish and Wildlife Service (USFWS) using their [Information for Planning and Consultation tool](#).
- This report contains information on wildlife species protected under the ESA and the [Wildlife Conservation Act \(WCA\)](#), [Species of Greatest Conservation Need \(SGCN\)](#) (page 18, table 5), and Species of Economic and Recreational Importance (SERI). Species listed under the ESA are protected from take at the federal level and under the WCA are protected from take at the state level. SGCN are identified in the [State Wildlife Action Plan \(SWAP\) for New Mexico](#); all of these species are considered to be of conservation concern but not all of them are protected from take at the state or federal level. The harvest of all SERI is regulated at the state level. The Department has no authority to designate critical habitat for species listed under the WCA; only the USFWS can designate critical habitat for species listed under the ESA.
- The New Mexico Environmental Review Tool (ERT) utilizes species observation locations and species habitat suitability models, both of which are subject to ongoing change and refinement. Inclusion or omission of a species within a report cannot guarantee species presence or absence within your project area. To determine occurrence of any species listed in this report, or other wildlife that may be present within your project area, onsite surveys conducted by a qualified biologist during appropriate, species-specific survey timelines may be necessary. Any surveys including handling or capturing wildlife may require a scientific collection permit; contact the Department's Wildlife Permits Manager at dgf.permits@dgf.nm.gov for more information.
- The Department encourages use of the ERT to modify proposed projects for avoidance, minimization, or mitigation of wildlife impacts. However, the ERT is not intended to be used in a repeatedly iterative fashion to adjust project attributes until a previously determined recommendation is generated. The ERT serves to assess impacts once project details are developed. The [New Mexico Crucial Habitat Assessment Tool](#), the data layers from which are included in the ERT, is the appropriate system for advising early-stage project planning and design to avoid areas of anticipated wildlife concerns and associated regulatory requirements.

NEDU Injection Leak

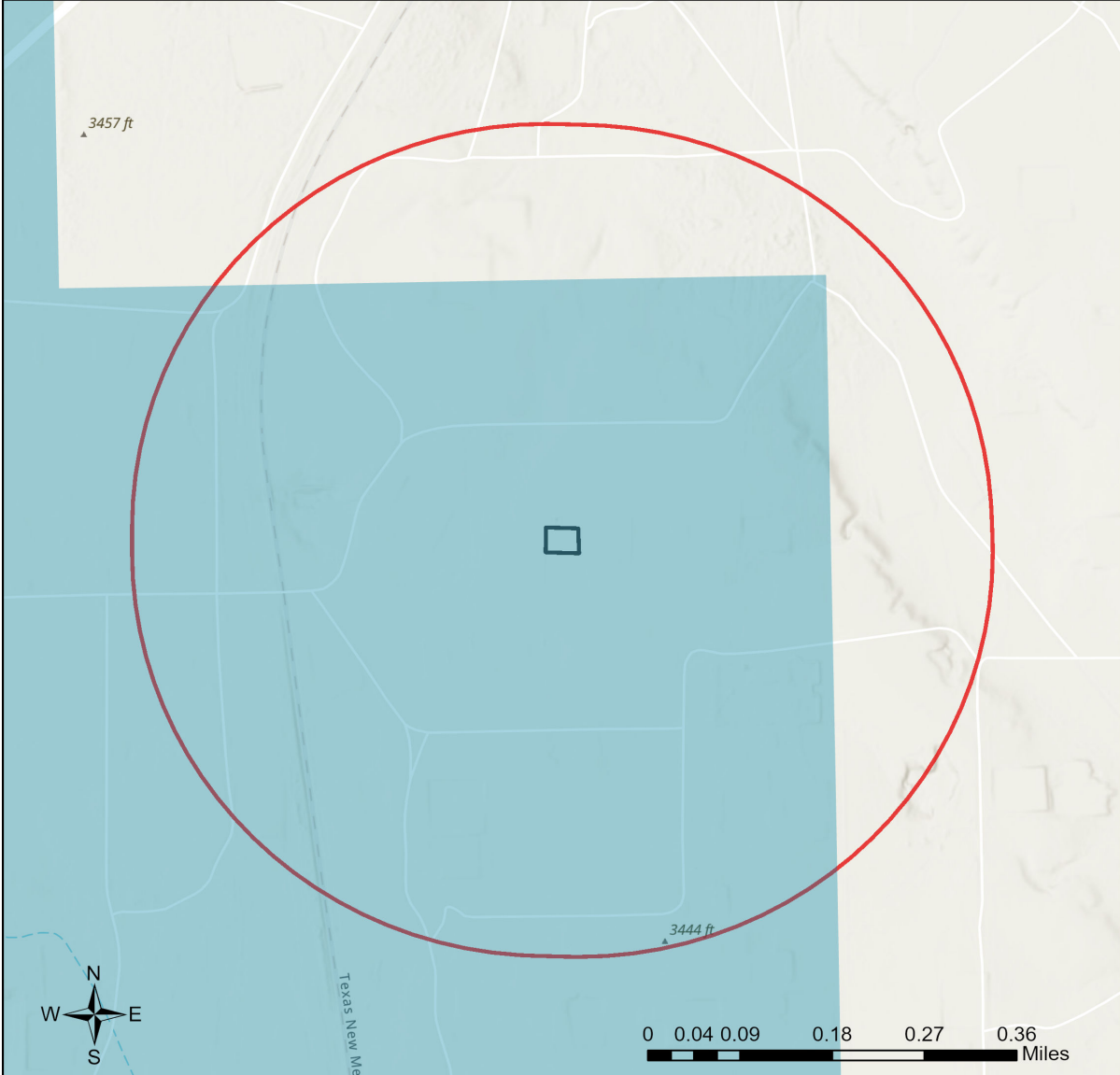

- | | | |
|---------------------------|------------------------------|---|
| Buffered Project Boundary | NM Department of Game & Fish | U.S. Army Corps of Engineers |
| Project_Boundary | NM State Forestry Division | U.S. Bureau of Reclamation |
| Bureau of Land Management | NM State Parks | U.S. Department of Agriculture |
| City Land | Other Federal Agency | U.S. Fish and Wildlife Service |
| County Land | Other Federal Agency | U.S. Forest Service |
| Department of Defense | State Land Office | U.S. Natural Resources Conservation Service |
| Department of Energy | State of New Mexico | |
| National Park Service | Tribal Land | |

NHNM, USGS, USFS, US Census Bureau, NMDGF
 Esri, NASA, NGA, USGS, FEMA
 Esri Community Maps Contributors, New Mexico State University, Texas Parks & Wildlife, CONANP, Esri, TomTom, Garmin, SafeGraph, GeoTechnologies, Inc, METI/NASA, USGS, EPA, NPS, US Census

Special Status Animal Species Potentially within 650 Meters of Project Area

Common Name	Scientific Name	USFWS (ESA)	NMDOW (WCA)	NMDOW SGCN/SERI	USFS	USFS SCC	BLM
Barking Frog	Craugastor augusti			SGCN			
Plains Leopard Frog	Lithobates blairi			SGCN			BLM WATCH
Clark's Grebe	Aechmophorus clarkii			SGCN			
American Bittern	Botaurus lentiginosus			SGCN			BLM WATCH
Aplomado Falcon	Falco femoralis		E	SGCN			
Peregrine Falcon	Falco peregrinus		T	SGCN			BLM WATCH
Elf Owl	Micrathene whitneyi			SGCN			BLM WATCH
Western Burrowing Owl	Athene cucularia hypugaea			SGCN	Sensitive Species	USFS R3 SCC	BLM SENSITIVE
Common Nighthawk	Chordeiles minor			SGCN			
Lewis's Woodpecker	Melanerpes lewis			SGCN		USFS R3 SCC	BLM WATCH
Bank Swallow	Riparia riparia			SGCN			
Pygmy Nuthatch	Sitta pygmaea			SGCN			
Sprague's Pipit	Anthus spragueii			SGCN			BLM SENSITIVE
Loggerhead Shrike	Lanius ludovicianus			SGCN		USFS R3 SCC	BLM WATCH
Vesper Sparrow	Poocetes gramineus			SGCN			
Thick-billed Longspur	Rhynchophanes mccownii			SGCN			BLM SENSITIVE
Chestnut-Collared Longspur	Calcarius ornatus			SGCN			BLM SENSITIVE
Black-Tailed Prairie Dog	Cynomys ludovicianus			SGCN	Sensitive Species		BLM SENSITIVE
Pronghorn	Antilocapra americana			SERI			
Western Ribbon Snake	Thamnophis proximus		T	SGCN	Sensitive Species		
Desert Massasauga	Sistrurus catenatus edwardsii			SGCN			

Common Name hyperlink takes you to species account in bison-m.org; Scientific Name hyperlink takes you to information in [NatureServe Explorer](#); ESA = Endangered Species Act, C = Candidate, LE = Listed Endangered, LT = Listed Threatened, XN = Non-essential Experimental Population, for other ESA codes see this [website](#); WCA = Wildlife Conservation Act, E = Endangered, T = Threatened; SERI = Species of Economic and Recreational Importance; SGCN = Species of Greatest Conservation Need; USFS = U.S.

Forest Service, Sensitive Species = A species likely to occur on USFS lands that is of concern for a potential reduction in population viability; SCC = Species of Conservation Concern; BLM = Bureau of Land Management, BLM SENSITIVE = A species that occurs on BLM lands and whose viability is at risk, BLM WATCH = Species that may be added to the sensitive species list in future pending new information regarding species status.

Special Status Plant Species Potentially within 650 Meters of Project Area

Common Name	Scientific Name	USFWS (ESA)	NMAC	NMRPCS	USFS	USFS SCC	BLM
Tharp's Blue Star	Amsonia tharpii		E				BLM SENSITIVE

NMAC = New Mexico Administrative Code, E = Endangered; NMRPCS = [New Mexico Rare Plant Conservation Strategy](#), SS = NM Rare Plant Conservation Strategy Species; USFS = U.S. Forest Service, Sensitive Species = A species likely to occur on USFS lands that is of concern for a potential reduction in population viability; SCC = Species of Conservation Concern; BLM = Bureau of Land Management, BLM SENSITIVE = A species that occurs on BLM lands and whose viability is at risk, BLM WATCH = Species that may be added to the sensitive species list in future pending new information regarding species status.

Project Recommendations

Your proposed project activities may require a custom review for assessment of potential effects to wildlife. See the "OVERALL STATUS" section above to determine the likelihood that your project will be reviewed further based on its location. A Department biologist will confirm whether any additional conservation measures are needed. You should expect to receive any additional project recommendations within 30 days of your project submission. If the "OVERALL STATUS" section indicates that no further consultation with the Department is required based on its location, then you will only receive additional project feedback from the Department if a biologist deems it necessary.

Burrowing owl (*Athene cunicularia*) may occur within your project area. Burrowing owls are protected from take by the Migratory Bird Treaty Act and under New Mexico state statute. Before any ground disturbing activities occur, the Department recommends that a preliminary burrowing owl survey be conducted by a qualified biologist using the Department's [Burrowing Owl Survey Protocol](#). Surveys including audio calls may require a scientific collection permit; contact the Department's Wildlife Permits Manager at dgf.permits@dgf.nm.gov for more information. Should burrowing owls be documented in the project area, please contact the Department or USFWS for further recommendations and information on any permitting requirements regarding relocation or avoidance of impacts.

Our preliminary assessment indicates your project occurs in Lesser Prairie-chicken Crucial Habitat Category 1 (Focal Area).

The Lesser Prairie-chicken (*Tympanuchus pallidicinctus*) (LPC) was designated as a SGCN in New Mexico and previously the southern Distinct Population Segment, including populations in New Mexico and Texas, was federally listed as Endangered. The LPC Interstate Working Group has developed the Southern Great Plains Crucial Habitat Assessment Tool ([SGP-CHAT](#)) to designate and prioritize areas for LPC conservation activities and development. Our preliminary assessment indicates your project occurs in LPC habitat. For more information on the SGP-CHAT, contact Chanda Pettie, Industry LPC Program Contact with the Western Association of Fish and Wildlife Agencies, at (719) 207-5053 or chanda.pettie@wafwa.org.

If your project has potential to lead to take (including harassment, harm, pursuit, hunting, shooting, wounding, killing, trapping, capturing, collecting, or attempting to engage in these activities) of a LPC and you entered into the Candidate Conservation Agreement (CCA) or CCA with Assurances (CCAA) for the LPC with [CEHMM](#), the Department recommends you contact CEHMM (575-885-3700). If your project may lead to take of a LPC and you did not enter the CCA/A with CEHMM, the Department recommends a qualified, permitted biologist conduct surveys for the LPC according to these [Lesser Prairie-chicken Survey Protocols](#) and mitigating the effects of project activities by buffering (>1.25 miles of known leks) and avoiding construction or off-road activities during the breeding season (March 1-July 15). Low-altitude aerial surveys or surveys based on flush counts may require a scientific collection permit; contact the Department's Wildlife Permits Manager at dgf.permits@dgf.nm.gov for more information.

Since your project occurs within Lesser Prairie-chicken habitat, the Department recommends the following:

- As much as possible, avoid development within focal areas, connectivity zones, or within 1.25 miles of known Lesser Prairie-chicken (LPC) leks that have been active at least once within the previous five years, as well as project sites dominated by tracts of native grass and shrublands (see Southern Great plains Crucial Habitat Assessment Tool [[SGP-CHAT](#)] and Department staff for more information).
- As much as possible, focus development on lands already altered or cultivated (e.g., in areas with row-crop agriculture or developed oilfields) and away from areas of undeveloped native grass or shrublands. Select fragmented or degraded habitats over relatively intact areas, and select sites with lower LPC habitat potential over sites with greater habitat potential based on appropriate indicators, including Natural Resources Conservation Service Ecological Site Descriptions, specifically loamy, loamy sand, sandhills, sandy, sandy plains, shallow sandy, and very shallow.
- Where avoidance is not possible, use common rights of way for multiple types of infrastructure in locating new roads, fences, power lines, well pads, flowlines, compressors, and other associated infrastructure.
- Reduce impacts by using directional drilling and clustering (i.e., multiple wells per pad, common tank batteries) where feasible or locating facilities to reduce habitat loss and fragmentation.
- During the LPC lekking, nesting, and brooding season (March 1–July 15) within 1.25 miles of leks recorded as active within the previous five years, avoid the following as much as feasible: 1) non-emergency operations and construction and maintenance activities, where humans are present; 2) conducting seismic and similar activities that require off-road travel in rangelands or areas with Conservation Reserve Program or other native, planted grass cover. If these activities cannot be avoided during these times in these areas, then avoid conducting them between 3:00 and 9:00 AM. Allowed emergency operations include those that address human or environmental safety concerns or relate directly to operational continuity such as: responses to spills or well-control incidents (i.e., incidents related to down-hole pressures during drilling, completion, recompletion, or production operations); equipment or r-line repairs; unloading one or more tanks to prevent them from overflowing; patrolling to locate known breaks in electrical service; and activities related to security (e.g., preventing theft and vandalism), making a well productive again, or unplanned construction and maintenance that cannot be delayed.
- Where avoidance of areas within 1.25 miles of a LPC lek recorded as active within the previous five years is not possible, institute noise abatement year-round for new facilities and ensure that noise does not exceed 75 dB when measured at any point greater than 30 feet from the facility boundary.
- LPC lek surveys, conducted by a qualified, permitted biologist, shall be required in areas located within SGP-CHAT categories 1-3 prior to conducting any breeding season seismic activities.

Prairie dog colonies may occur within the vicinity of your project area. Both black-tailed prairie dogs (*Cynomys ludovicianus*) and Gunnison's prairie dogs (*Cynomys gunnisoni*) are designated as New Mexico SGCN, and their colonies provide important habitat for other grassland wildlife. Wherever possible, occupied prairie dog colonies should be left undisturbed, and all project activities should be directed off the colony. Any burrows that are located on the project site should be surveyed by a qualified biologist to determine whether burrows are active or inactive and whether burrowing owls may be utilizing the site. Colonies within the range of the black-tailed prairie dog can be surveyed by a qualified biologist diurnally, year-round using binoculars. Colonies within the range of the Gunnison's prairie dog can be surveyed by a qualified biologist diurnally, using binoculars during the warmer months from April through October and by searching for fairly fresh scat and lack of cobwebs or debris at the mouths of burrows during the cold months (November through March). If ground-disturbing activities cannot be relocated off the prairie dog colony, or if project activities involve control of prairie dogs, the Department recommends live-trapping and relocation of prairie dogs. A scientific collection permit may be required; contact the Department's Wildlife Permits Manager at dgf.permits@dgf.nm.gov for more information. The Department can provide recommendations regarding suitability of potential translocation areas and procedures. If a project will only impact 10 or fewer burrows and there is a large, active colony adjacent to the site the continued existence of which will not cause future conflicts, the Department suggests use of reverse dispersal translocation methods as outlined in [Creating Prairie Dog Management Plans Part three: Appendices and Attachments](#) (see Attachment 1). Methods include setting up a wire door over active burrows followed by monitoring and closure of the few burrows in the project disturbance area after prairie dog evacuation and barrier installation to prevent recolonization of closed areas. Removal activities should be performed after the spring breeding and birthing seasons and prior to winter hibernation (e.g., mid-June to mid-November). Prairie dogs in southern New Mexico may remain active in the winter, extending the potential removal period beyond mid-November. Removal activities should also begin roughly one month before construction or other disturbance occurs as it can take between one week and one month for the animals to disperse.

Your project could affect important components of wildlife habitat, including fawning/calving or wintering areas for species such as deer and elk, or general high wildlife movement and activity areas for large mammals. Mitigation measures should focus on high use sites and movement areas based on extant collar data and expert knowledge of Department of Wildlife and land management agency personnel. Management recommendations within these areas may include the following.

- Restrictions on noise-generating activities during wintering and calving/fawning seasons, specific timing of which may vary throughout the state. These activities would include oil and gas well pad development and operations that expose wildlife to loud noises from drilling, compressors, and pumping stations within 400 feet of the source.
- Modifying fences along high use areas to make them wildlife friendly and facilitate large animal movement.

Disclaimers regarding recommendations:

- The Department provides technical guidance to support the persistence of all protected species of native fish and wildlife, including game and nongame wildlife species. Species listed within this report include those that have been documented to occur within the project area, and others that may not have been documented but are projected to occur within the project vicinity.
- Recommendations are provided by the Department under the authority of § 17-1-5.1 New Mexico Statutes Annotated 1978, to provide "communication and consultation with federal and other state agencies, local governments and communities, private organizations and affected interests responsible for habitat, wilderness, recreation, water quality and environmental protection to ensure comprehensive conservation services for hunters, anglers and nonconsumptive wildlife users".
- The Department has no authority for management of plants or Important Plant Areas. The [New Mexico Endangered Plant Program](#), under the Energy, Minerals, and Natural Resources Department's Forestry Division, identifies and develops conservation measures necessary to ensure the survival of plant species within New Mexico. Plant status information is provided within this report as a courtesy to users. Recommendations provided within the ERT may not be sufficient to preclude impacts to rare or sensitive plants, unless conservation measures are identified in coordination with the Endangered Plant Program.
- Additional coordination and/or consultation may also be necessary under the federal ESA or National Environmental Policy Act (NEPA). Further site-specific mitigation recommendations may be proposed during ESA consultation and/or NEPA analyses or through coordination with affected federal agencies.
- Unless a project is marked as confidential in the title or description by the project proponent and if a ERT-generated report is the only response that the project proponent receives from the Department, then the report will be made publicly accessible via the [Public Comment Letters](#) page on the ERT website.