



PROJECT INFORMATION

Project Title: D21139 FIRSTNET / SAC Wireless / Rio Arriba County, NM
Project Type: COMMUNICATIONS, TOWERS (CELLULAR AND OTHER), CELL TOWERS LESS THAN 200 FT, NO GUY WIRES, AND WITHIN DEVELOPED AREA
Latitude/Longitude (DMS): 36.711374 / -106.562603
County(s): RIO ARRIBA
Project Description: SAC Wireless, LLC on behalf of AT&T and Commnet, proposes to construct a telecommunications tower and a 30 by 30 ft. lease area to be located at approximately 14 County Road 324, Tierra Amarilla, Rio Arriba County, New Mexico. The facility will include a self-supporting telecommunications tower with an approximate overall height of 70 ft. Access easement will extend generally northeast and connect with existing gravel access road on the parent parcel which connects with Highway 84. Utilities will tie into existing power on the parent parcel.

REQUESTOR INFORMATION

Project Organization:
Contact Name: Jennet Nguyen
Email Address: jnguyen@gssmidwest.com
Organization: GSS, Inc.
Address: 1054 Texan Trail, Suite #300, Grapevine TX 76051
Phone: 5154995737

OVERALL STATUS

The information contained within this report comprises the recommendations of the New Mexico Department of Game and Fish (Department) for management and mitigation of proposed project impacts to wildlife and habitat resources; see the Project Recommendations section below for further details. No further consultation with the Department is required based on the project's location and, with implementation of mitigation measures described in the Project Recommendations section below, no adverse effects to wildlife or important habitats are anticipated. However, a Department biologist may be in touch within 30 days if they determine that further review is required.



About this report:

- This environmental review is based on the project description and location that was entered. The report must be updated if the project type, area, or operational components are modified.
- This is a preliminary environmental screening assessment and report. It is not a substitute for the potential wildlife knowledge gained by having a biologist conduct a field survey of the project area. Federal status and plant data are provided as a courtesy to users. The review is also not intended to replace consultation required under the federal Endangered Species Act (ESA), including impact analyses for federal resources from the U.S. Fish and Wildlife Service (USFWS) using their [Information for Planning and Consultation tool](#).
- The New Mexico Environmental Review Tool (ERT) utilizes species observation locations and species distribution models, both of which are subject to ongoing change and refinement. Inclusion or omission of a species within a report can not guarantee species presence or absence at a precise point location, as might be indicated through comprehensive biological surveys. Specific questions regarding the potential for adverse impacts to vulnerable wildlife populations or habitats, especially in areas with a limited history of biological surveys, may require further on-site assessments.
- The Department encourages use of the ERT to modify proposed projects for avoidance, minimization, or mitigation of wildlife impacts. However, the ERT is not intended to be used in a repeatedly iterative fashion to adjust project attributes until a previously determined recommendation is generated. The ERT serves to assess impacts once project details are developed. The [New Mexico Crucial Habitat Assessment Tool](#) is the appropriate system for advising early-stage project planning and design to avoid areas of anticipated wildlife concerns and associated regulatory requirements.



D21139 FIRSTNET / SAC Wireless / Rio Arriba County, NM

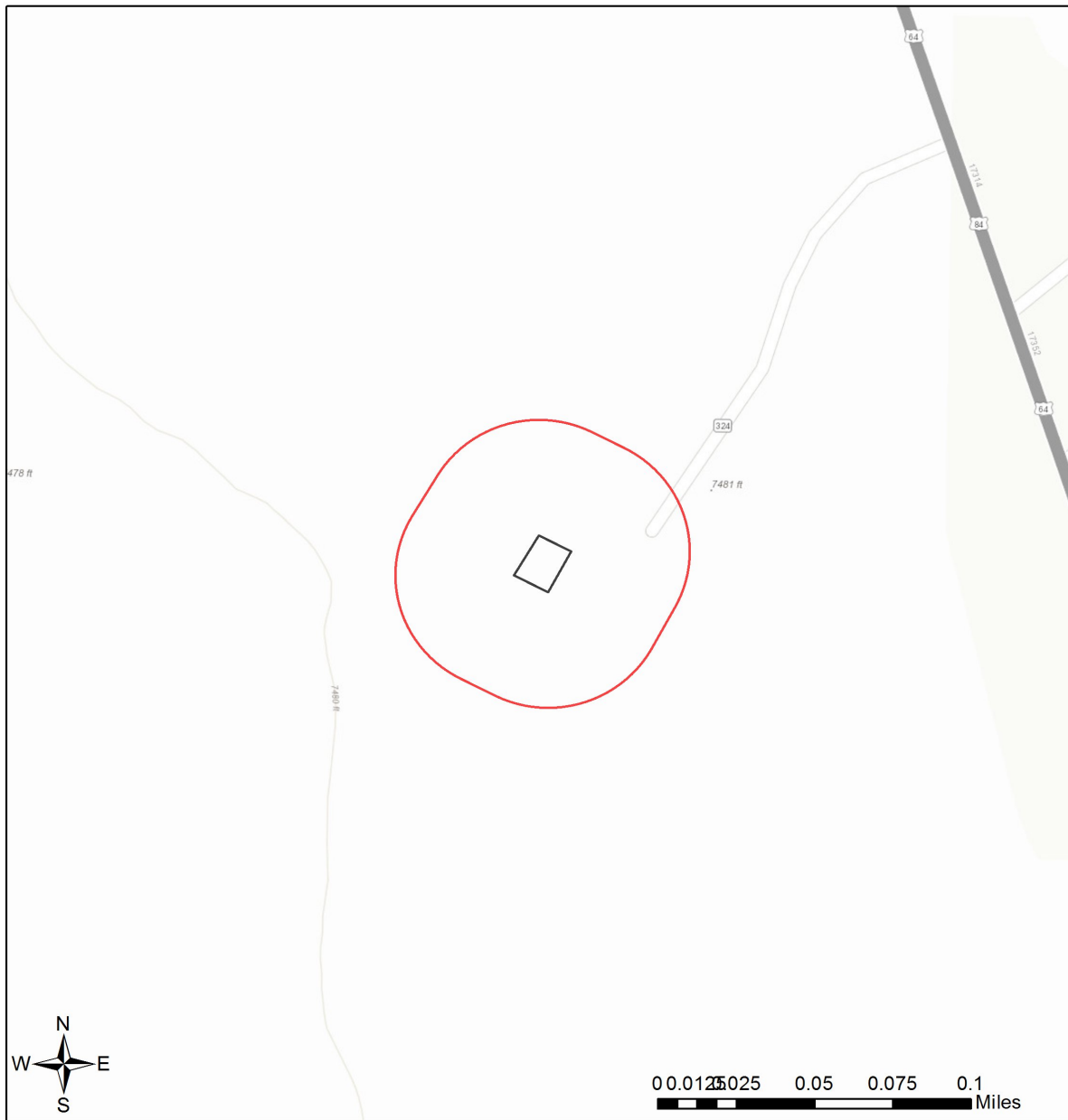

- | | | |
|---------------------------------|----------------------|----------------------|
| Project Boundary | Military | Private |
| Buffered Project Boundary | Dept. of Energy | State Land Office |
| NM_SurfaceOwnership_2016 | | |
| Bureau of Land Management | US Forest Service | NM Game & Fish Dept. |
| Bureau of Reclamation | Wildlife Area/Refuge | State Park |
| US Dept. of Agriculture | Tribal | |
| | National Park/Mon. | |

Sources: Esri, HERE, Garmin, Intermap, increment P Corp., GEBCO, USGS, FAO, NPS, NRCAN, GeoBase, IGN, Kadaster NL, Ordnance Survey, Esri Japan, METI, Esri China (Hong Kong), (c) OpenStreetMap contributors, and the GIS User Community



Special Status Animal Species within 200 Feet of Project Area

Common Name	Scientific Name	USFWS (ESA)	NMDGF (WCA)	NMDGF SGCN/SERI
Western Toad	Anaxyrus boreas	PS	E	SGCN
Northern Leopard Frog	Lithobates pipiens			SGCN
Peregrine Falcon	Falco peregrinus		T	SGCN
Mountain Plover	Charadrius montanus			SGCN
Lewis's Woodpecker	Melanerpes lewis			SGCN
Williamson's Sapsucker	Sphyrapicus thyroideus			SGCN
Olive-Sided Flycatcher	Contopus cooperi			SGCN
Bank Swallow	Riparia riparia			SGCN
Pinyon Jay	Gymnorhinus cyanocephalus			SGCN
Clark's Nutcracker	Nucifraga columbiana			SGCN
Juniper Titmouse	Baeolophus ridgwayi			SGCN
Pygmy Nuthatch	Sitta pygmaea			SGCN
Western Bluebird	Sialia mexicana			SGCN
Loggerhead Shrike	Lanius ludovicianus			SGCN
Brown-Capped Rosy-Finch	Leucosticte australis			SGCN
Spotted Bat	Euderma maculatum		T	SGCN
American Pika	Ochotona princeps			SGCN
Gunnison's Prairie Dog	Cynomys gunnisoni			SGCN
Cougar	Puma concolor			SERI

ESA = Endangered Species Act, WCA = Wildlife Conservation Act, SGCN = Species of Greatest Conservation Need, SERI = Species of Economic and Recreational Importance

Special Status Plant Species within 200 Feet of Project Area

Common Name	Scientific Name	USFWS (ESA)	NMAC	NMRPCS
Pagosa Phlox	Phlox caryophylla			SS

NMAC = New Mexico Administrative Code, NMRPCS = [New Mexico Rare Plant Conservation Strategy](#), SS = NM Rare Plant Conservation Strategy Species

Project Recommendations

With implementation of the applicable mitigation or avoidance measures included in the project description, and incorporation of the guidance listed below, the Department does not anticipate significant impacts to wildlife or sensitive wildlife habitats from the proposed project activities. See the "OVERALL STATUS" section above to determine the likelihood that your project will be reviewed further based on its location. If a Department biologist determines that additional conservation measures are needed, then you should expect to receive notification and/or any additional project recommendations within 30 days of your project submission.



Disclaimers regarding recommendations:

- The Department provides technical guidance to support the persistence of all protected species of native fish and wildlife, including game and nongame wildlife species. Species listed within this report include those that have been documented to occur within the project area, and others that may not have been documented but are projected to occur within the project vicinity.
- Recommendations are provided by the Department under the authority of § 17-1-5.1 New Mexico Statutes Annotated 1978, to provide "communication and consultation with federal and other state agencies, local governments and communities, private organizations and affected interests responsible for habitat, wilderness, recreation, water quality and environmental protection to ensure comprehensive conservation services for hunters, anglers and nonconsumptive wildlife users".
- The Department has no authority for management of plants or Important Plant Areas. The [New Mexico Endangered Plant Program](#), under the Energy, Minerals, and Natural Resources Department's Forestry Division, identifies and develops conservation measures necessary to ensure the survival of plant species within New Mexico. Plant status information is provided within this report as a courtesy to users. Recommendations provided within the ERT may not be sufficient to preclude impacts to rare or sensitive plants, unless conservation measures are identified in coordination with the Endangered Plant Program.
- Additional coordination may also be necessary under the federal ESA or National Environmental Policy Act (NEPA). Further site-specific recommendations may be proposed during ESA and/or NEPA analyses, or through coordination with affected federal agencies.